

skyvote®

User Manual

Table of Contents

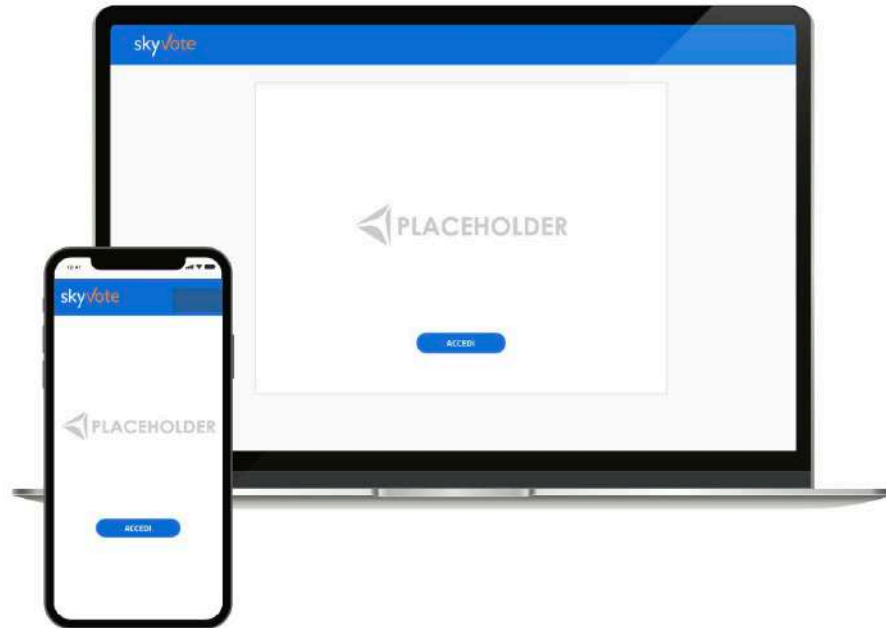

■ Access	3-6
■ Prerequisites	7
■ Polling Booth	8-12
■ Contacts	13

POLLING BOOTH ACCESS

AUTHENTICATION PROCESS

To access the polling booth, use your **Luiss account** credentials by clicking on the dedicated election link.

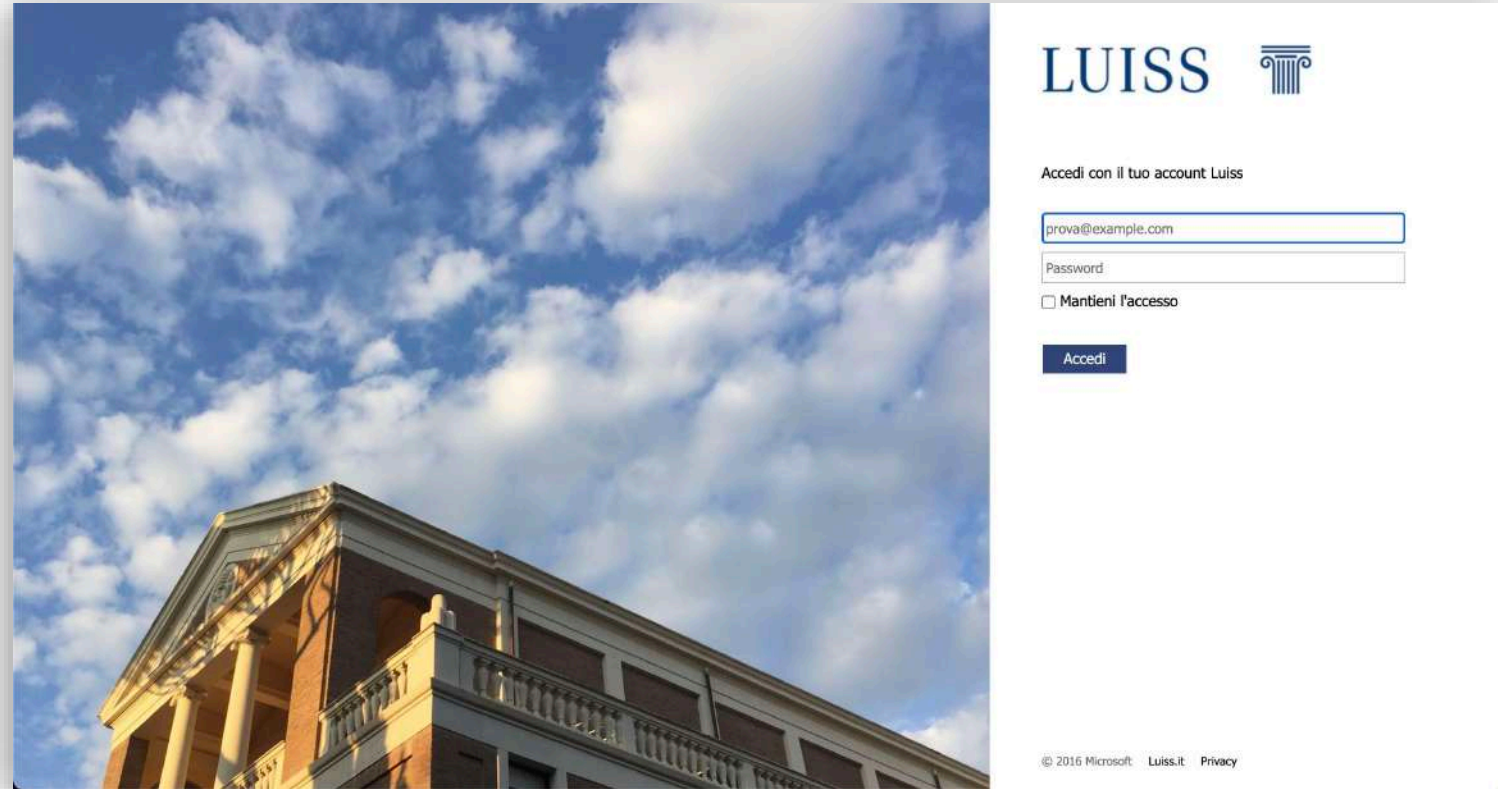

POLLING BOOTH ACCESS

CHOOSING THE LANGUAGE

When logging in to the system, choose the language with which you wish to continue.

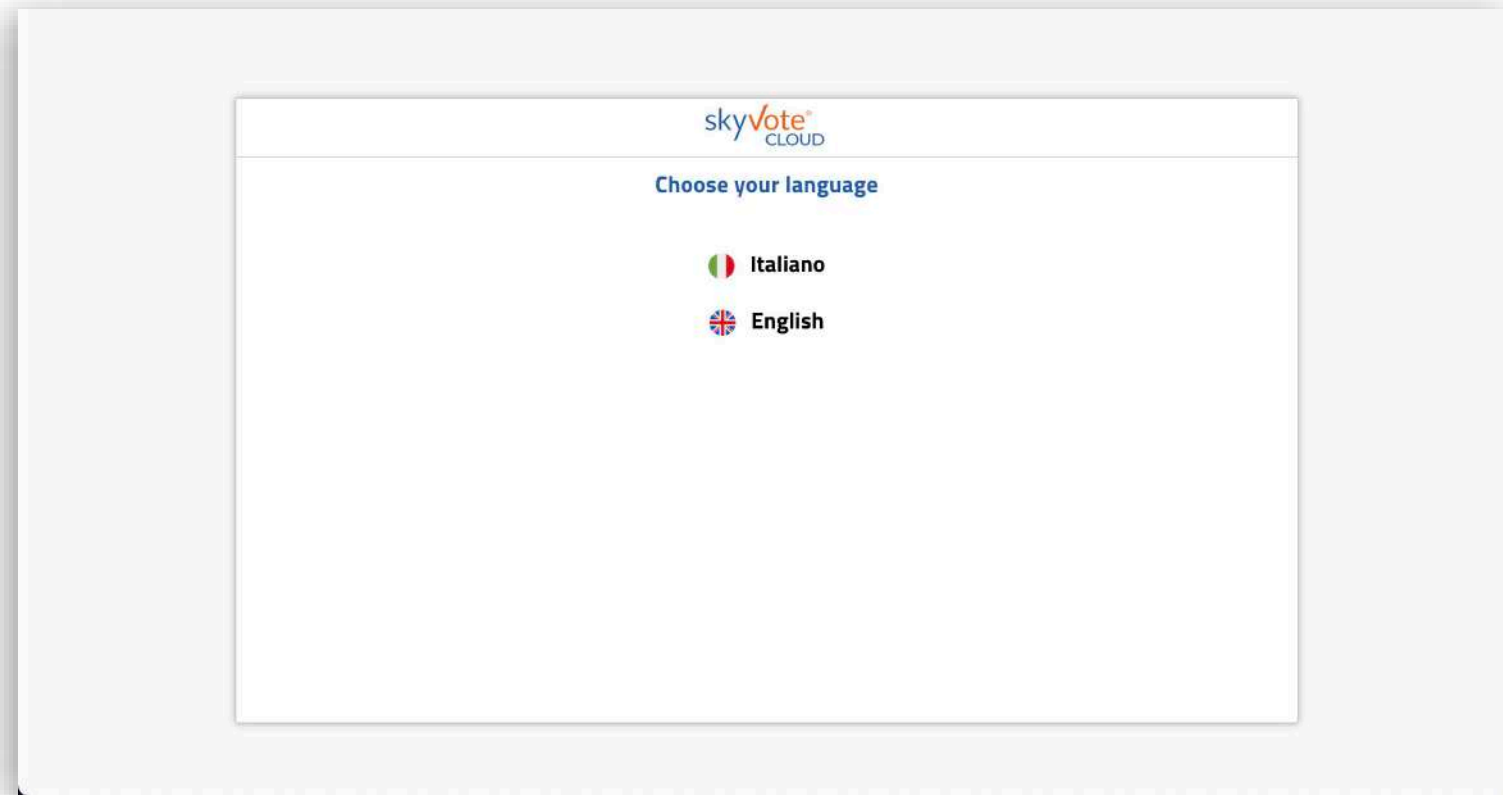

POLLING BOOTH ACCESS

CURRENT ELECTIONS

Select the election for which you wish to cast your vote.

NB: *Should you have already voted, the voting receipt will appear next to the name of the election.*

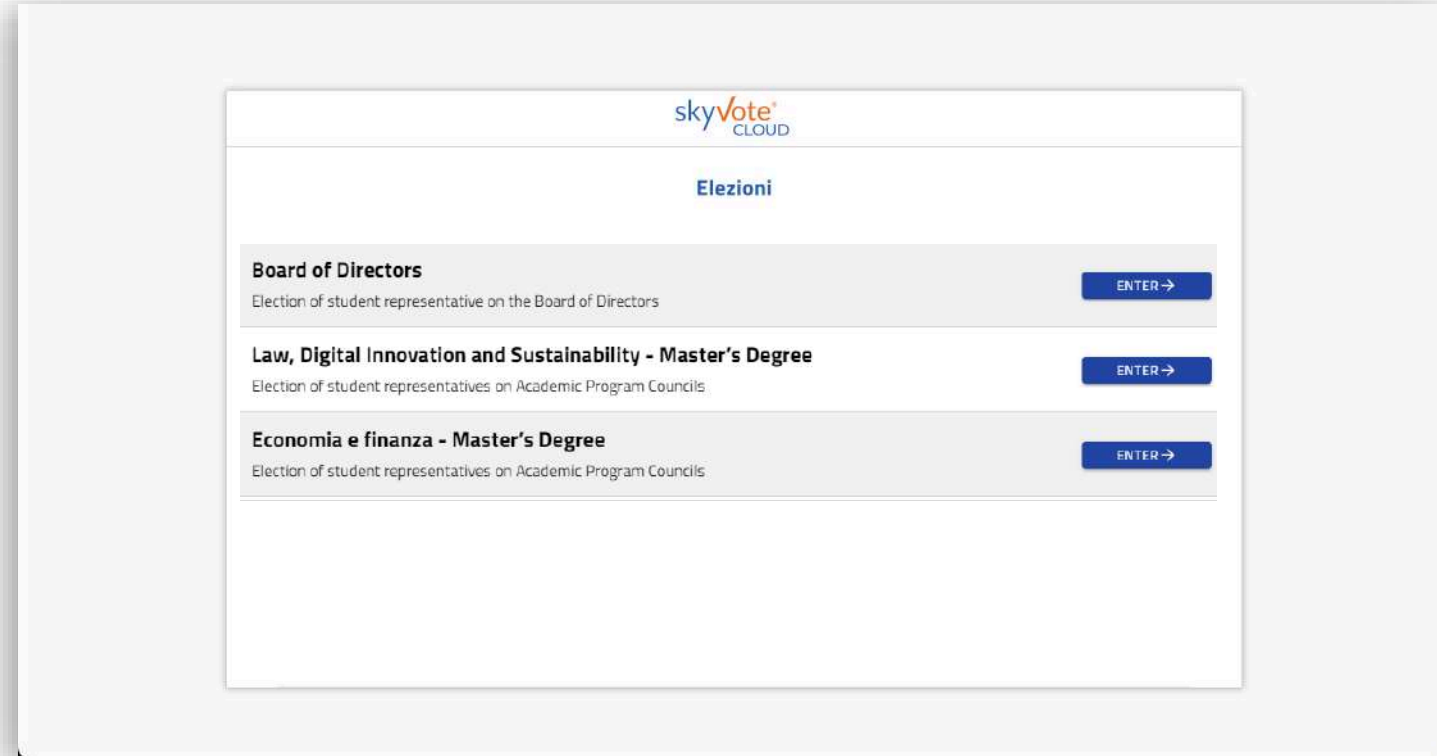

POLLING BOOTH ACCESS

CONSENT TO THE PROCESSING OF PERSONAL DATA

Accept the conditions relating to the processing of personal data and the terms of the privacy policy by reading all the way to the end.

NB: *You cannot continue unless you scroll to the bottom of the page.*

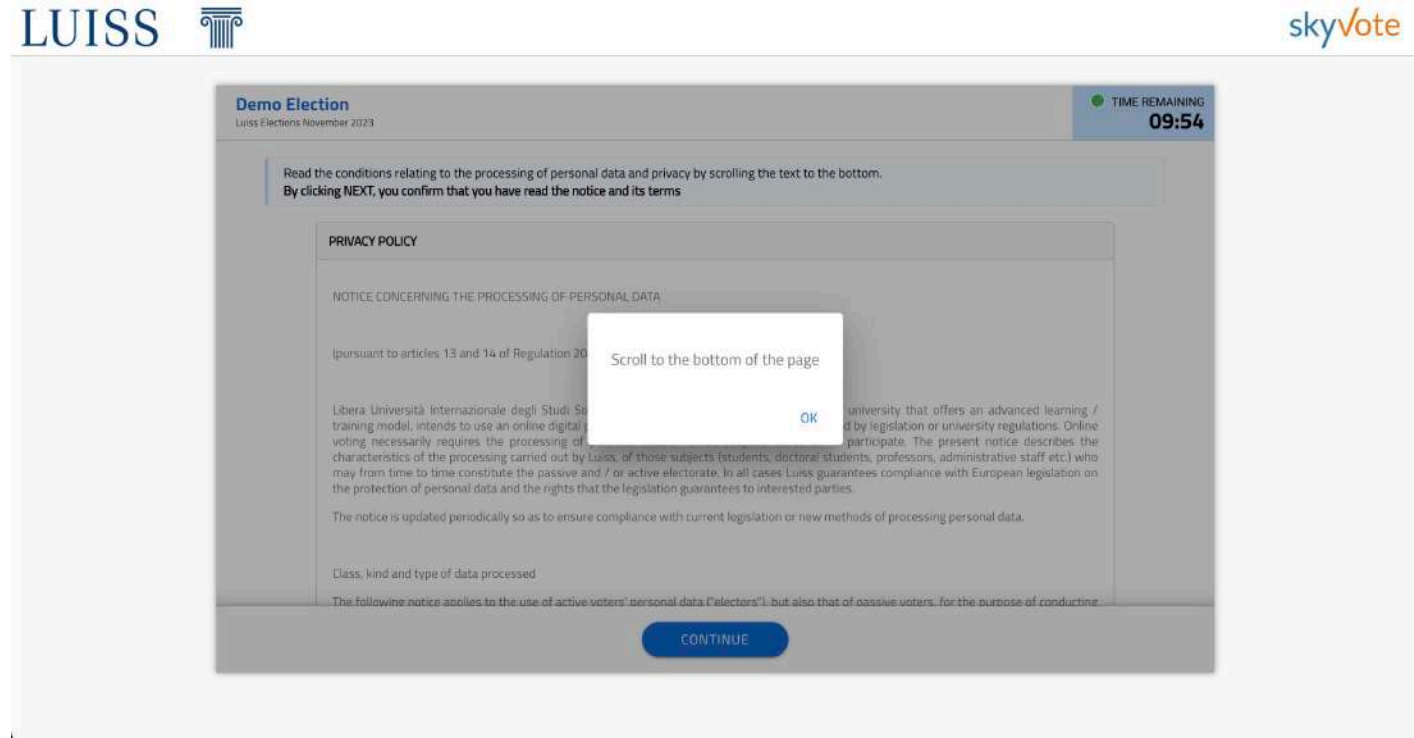

PREREQUISITES

ASSUMPTION OF RESPONSIBILITY

Confirm the declaration of accountability provided for by the regulations by clicking on the relevant checkbox.

NB: *You will be able to continue only after confirming the declaration.*

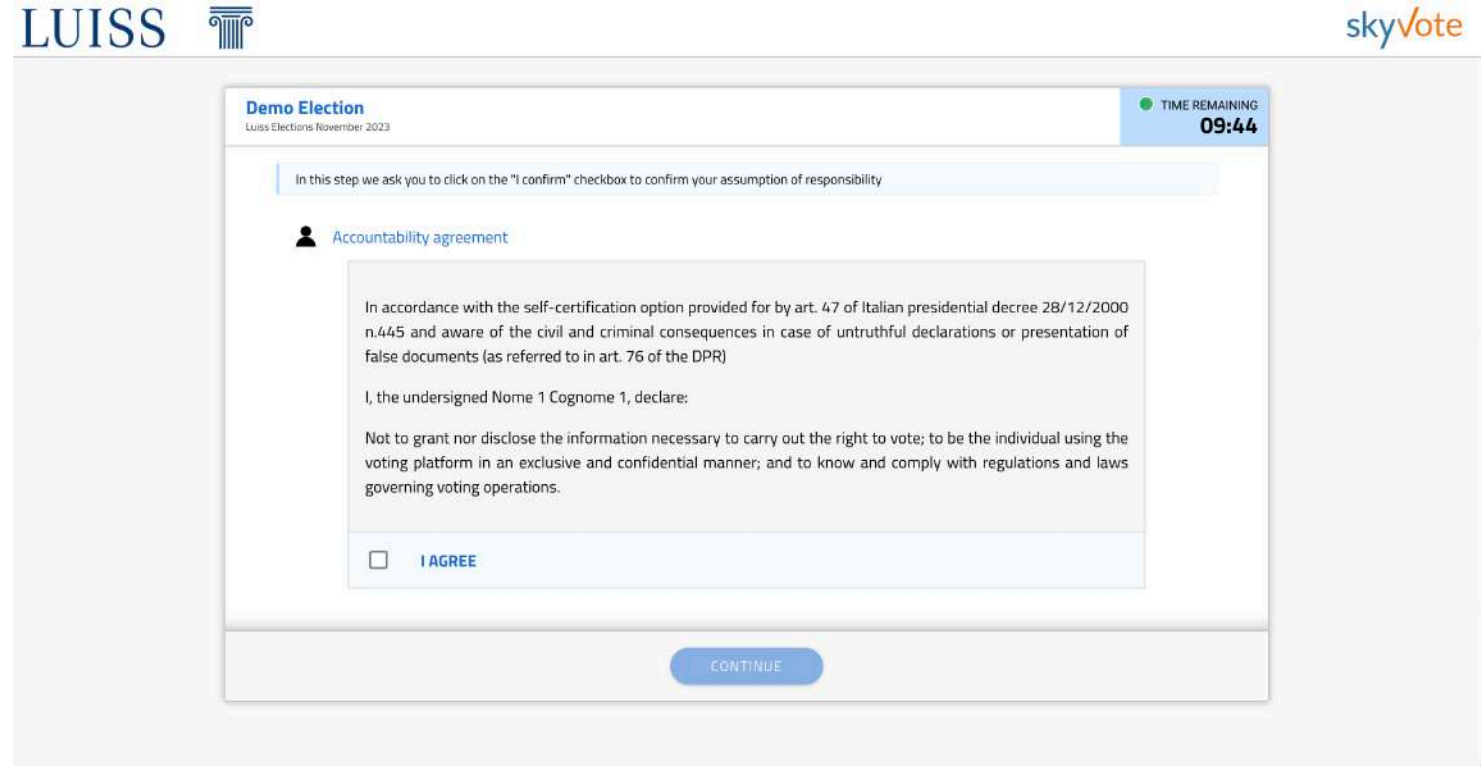

The screenshot displays the skyVote interface for a 'Demo Election' (Luiss Elections November 2023). The page features the LUISS logo and a 'skyVote' logo in the top right corner. A 'TIME REMAINING' indicator shows 09:44. The main content area is titled 'Accountability agreement' and contains the following text:

In accordance with the self-certification option provided for by art. 47 of Italian presidential decree 28/12/2000 n.445 and aware of the civil and criminal consequences in case of untruthful declarations or presentation of false documents (as referred to in art. 76 of the DPR)

I, the undersigned Nome 1 Cognome 1, declare:

Not to grant nor disclose the information necessary to carry out the right to vote; to be the individual using the voting platform in an exclusive and confidential manner; and to know and comply with regulations and laws governing voting operations.

At the bottom of the form, there is a checkbox labeled 'I AGREE' and a 'CONTINUE' button.

POLLING BOOTH

The polling booth consists of the following parts:

- 1) The top right-corner indicates how much time each voter has left to cast his or her vote
- 2) Ballot paper (“voting card”) information banner
- 3) Description of how to vote

NB: To start the voting process, scroll to the bottom of the page, noting all of the candidates.

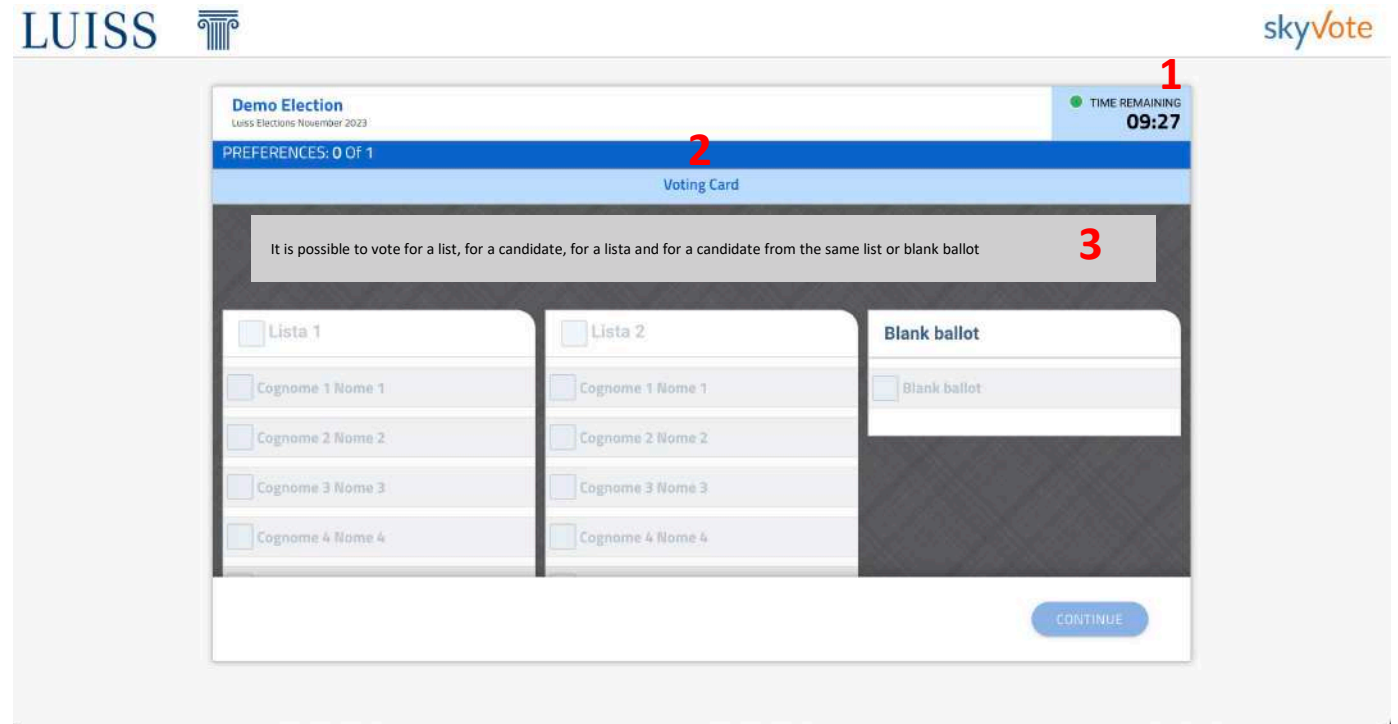

POLLING BOOTH

The central part contains the ballot paper with the lists and candidates that can be selected.

LIST SELECTION

MAX 1 PREFERENCE

Voters can select only **1 list**.

Clicking the "CONTINUE" button allows voters to confirm their choice.

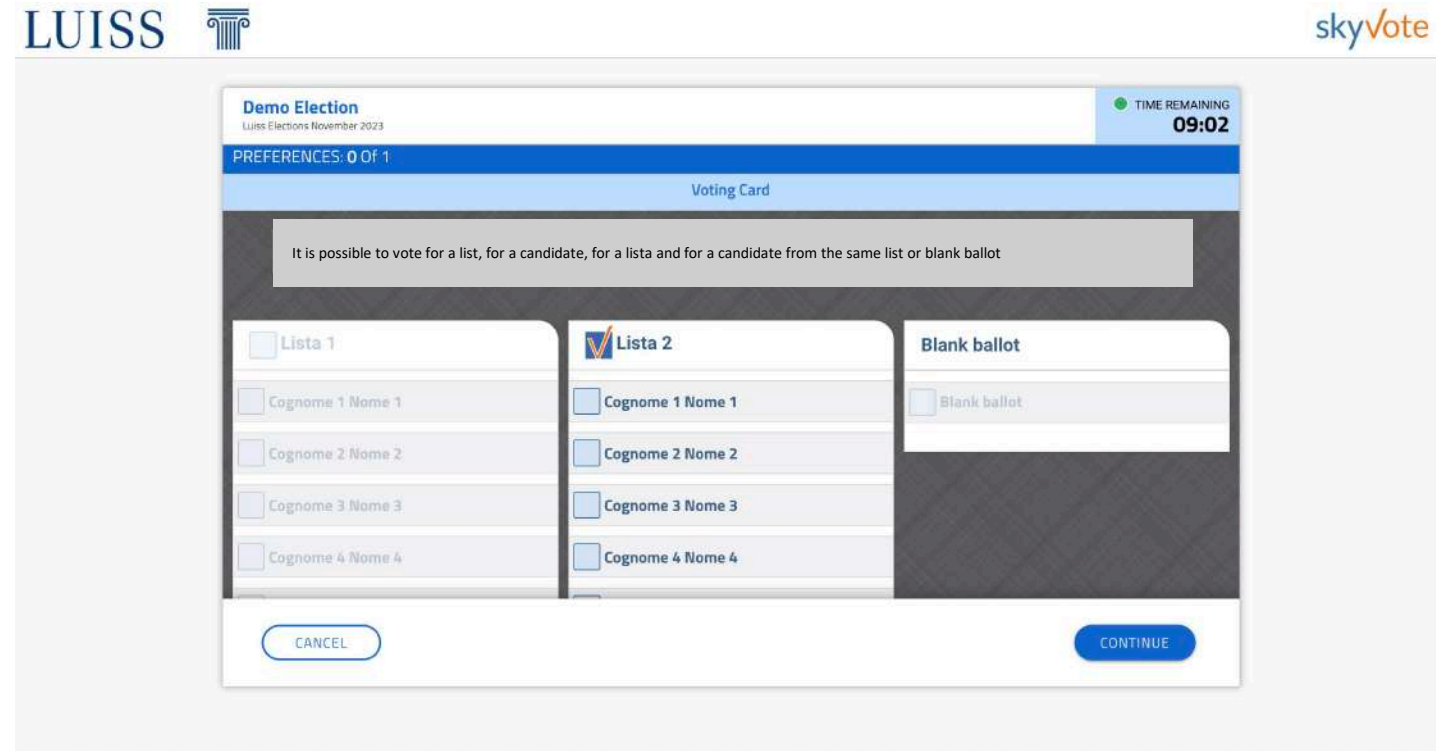

POLLING BOOTH

CANDIDATE SELECTION

MAX 1 PREFERENCE

Voters can select a maximum of **1 candidate** of the same list.

Clicking the "CONTINUE" button allows voters to confirm their choice.

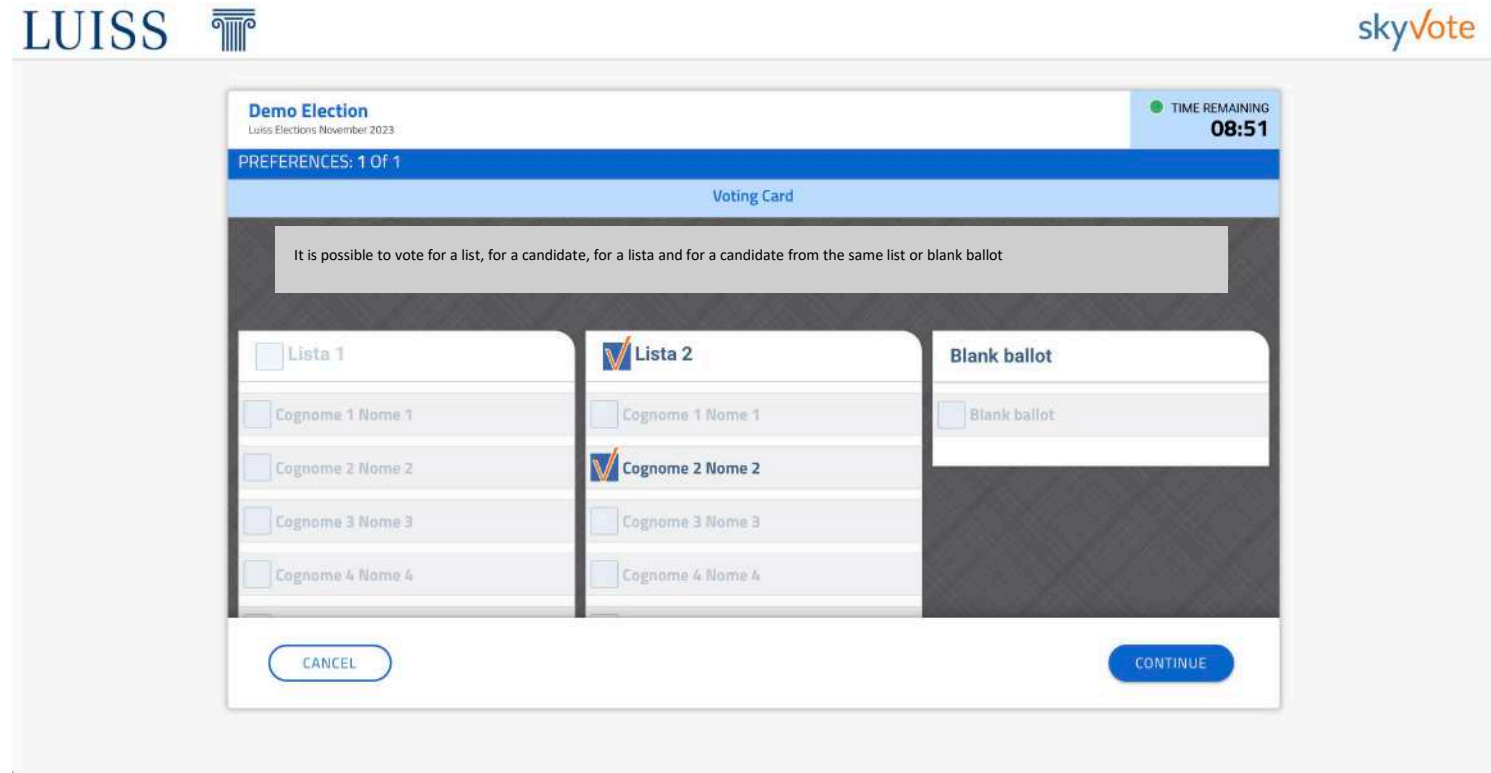

POLLING BOOTH POP-UP SUMMARY

The pop-up summary of the choice made is a confirmation tool to be sure that you have selected correctly and according to your wishes.

At this stage you can still change your mind and go back by clicking on the **"CANCEL"** button. By contrast, clicking on the **"SEND VOTE"** button will make your choice final and you will not be able to go back thereby moving on to the next ballot paper.

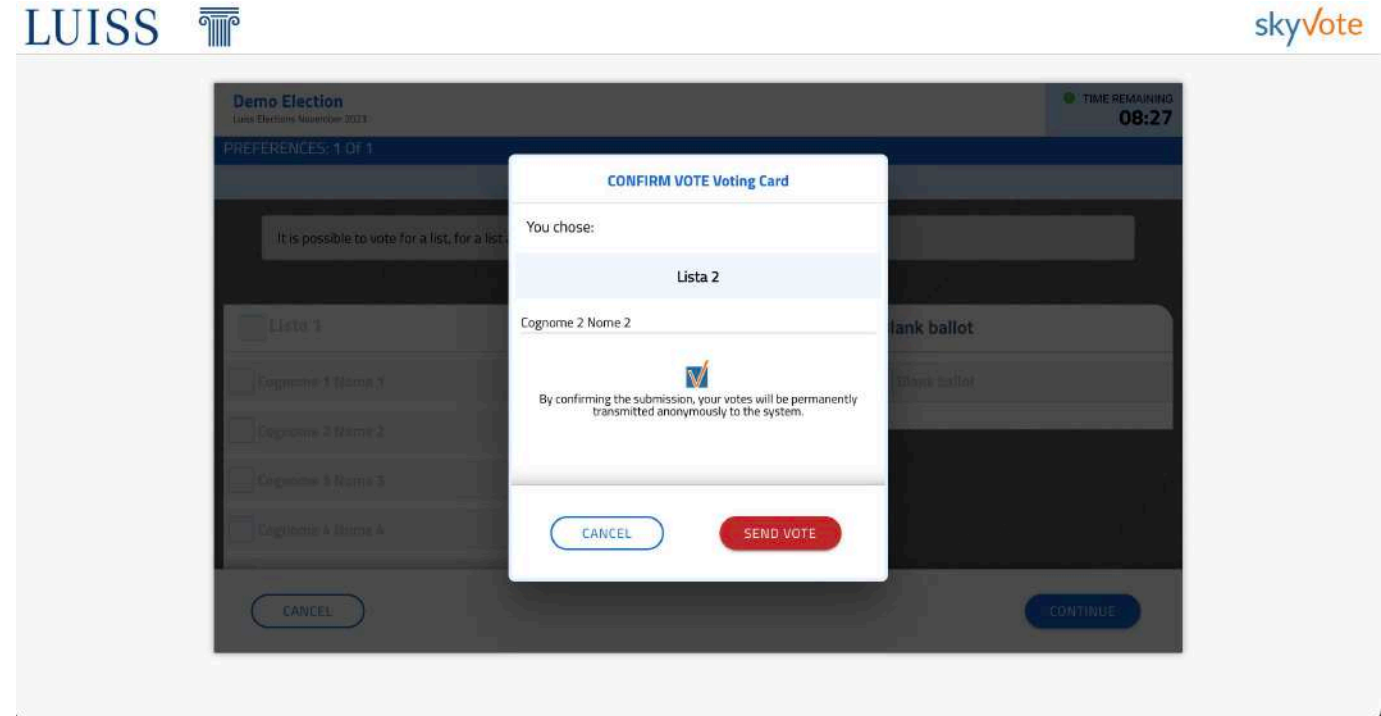

POLLING BOOTH VOTING RECEIPT

At the conclusion of the voting process, a voting receipt is displayed in the form of a code certifying that the vote has been successfully cast. This receipt is used to show that you have voted and that the vote has been recorded correctly by the system. This information will be sent by **E-MAIL** and you can also print it out by clicking on the appropriate button.

NB: If at the end of the procedure this receipt is not displayed, it means that the system has not recorded the vote correctly and the voter will have to repeat the process from the beginning.

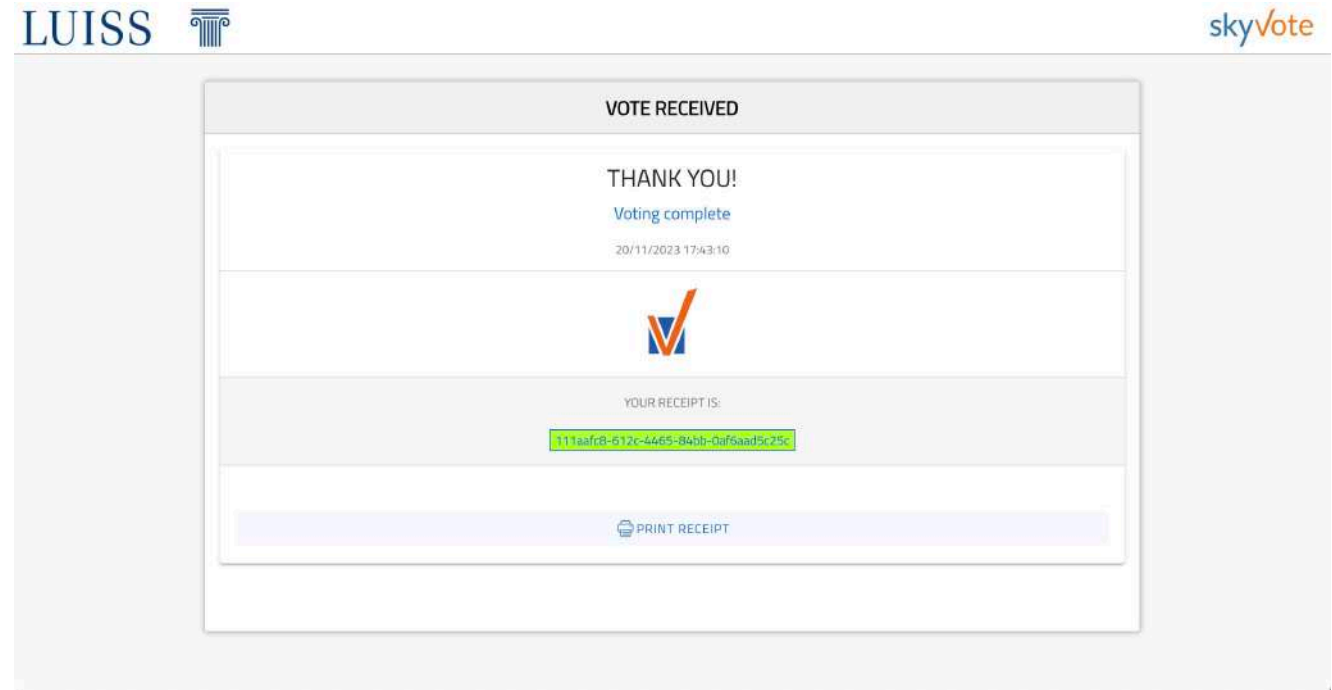

User Manual

Contacts

For any need please contact:

governance@luiss.it

06.85225246

06.85225260

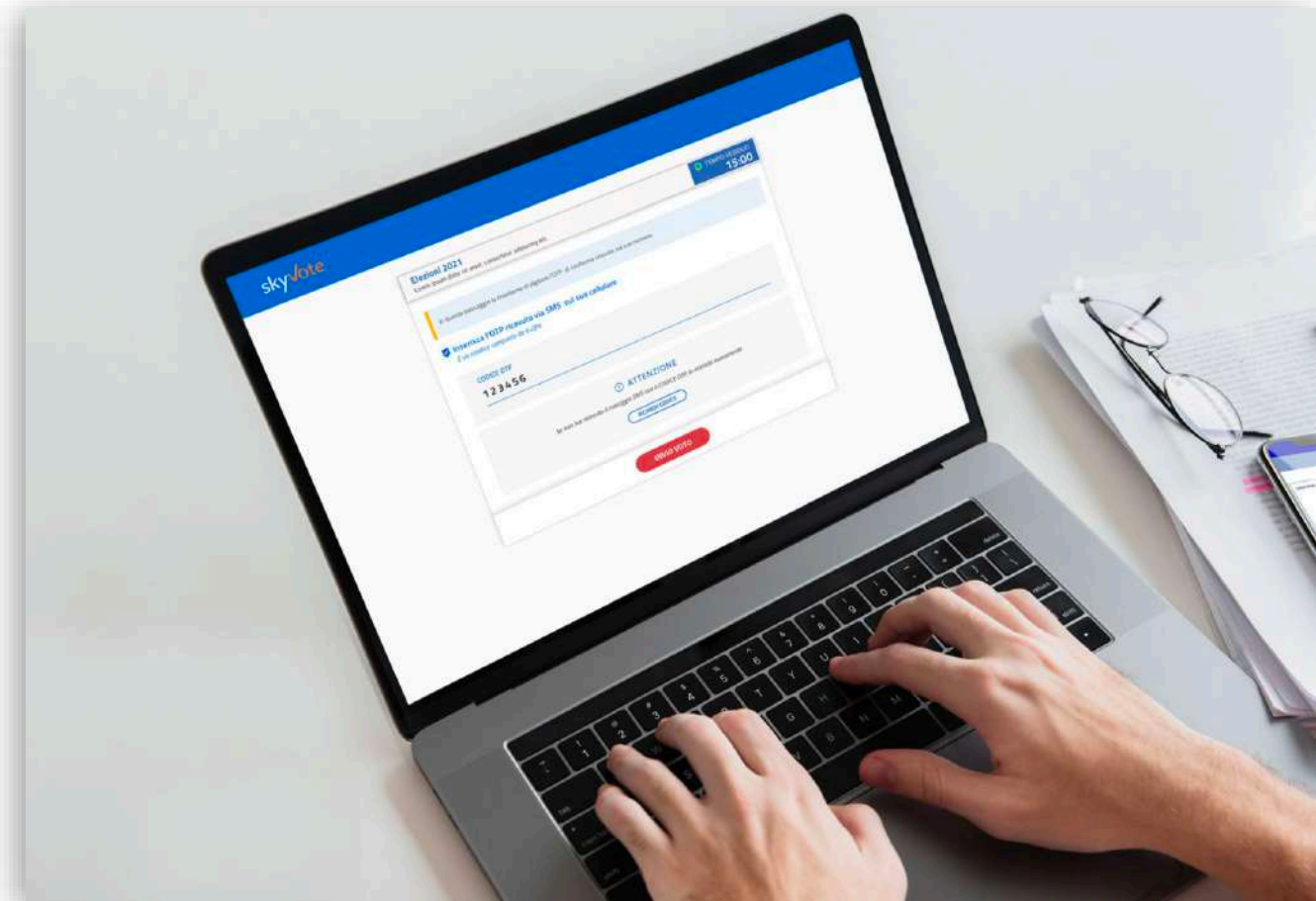

skyvote®

www.skyvote.it